

DLMA SERIES LED MULTIFUNCTION DOWN LIGHT



- ✓ 9 IN 1 Multifunction Feature
- ✓ UL, ETL, and Energy Star Certified
- ✓ Easy One Piece Install
- ✓ 50,000 Hour Rated Lifetime
- ✓ Optional Emergency Battery Backup
- ✓ 3 Adjustable Color Temperatures and Power Outputs

Nominal Specifications

LifeLux™ STD Rating
Selectable Power Setting
 6 inch: 8.5W, 13.5W, 21W
 8 inch: 12W, 19W, 26W
Voltage
 100-277V
Lumen Output
 85 Lm/W
Color Temperature
 3000K, 3500K, 4000K (adjustable)

Design Life
 50,000 hrs
CRI
 >80
Power Factor
 >0.90
Warranty
 5 Year Manufacturers Limited Warranty

Certifications
 UL, ETL, Energy Star
Dimensions
 6 inch - 6" Diameter x 7.25" Depth
 8 inch - 8" Diameter x 8" Depth

ORDERING DATA: Per chart below
 Example : USALED-DLMA-6-8.5-EM

xxxxxx	xxxxxx	xxxxxx	xxxxxx	xxxxxx
USALED	Model DLMA	Size 6 = 6 inch 8 = 8 inch	Wattage 8.5 = 8.5W, 13.5W, 21W (selectable) 12 = 12W, 19W, 26W (selectable)	Options EM = Emergency Backup

Additional Photos:



Note : Suitable for Dry and Damp Locations

FEATURES

- UV and IR Free
- 0-10V Dimming Options, With Some variable beam angles
- Allows flickerless dimming

APPLICATIONS

Offices, Retail Stores, Hospitals, Hotels, Restaurants, and other Commercial Buildings





Installation Summary: (Detailed Instructions provided with Product)

1. Turn off Power.
2. Disconnect the existing fixture and remove.
3. Open the driver cover on the backside of the panel with a screwdriver.
4. Select the desired color temperature and wattage.
5. Connect the wire leads to the fixture tail, securing as necessary.
6. Close and reattach the driver cover.
7. Secure the downlight into place.
8. Test Light to ensure the electrical connection is sound.

Retrofit Installation

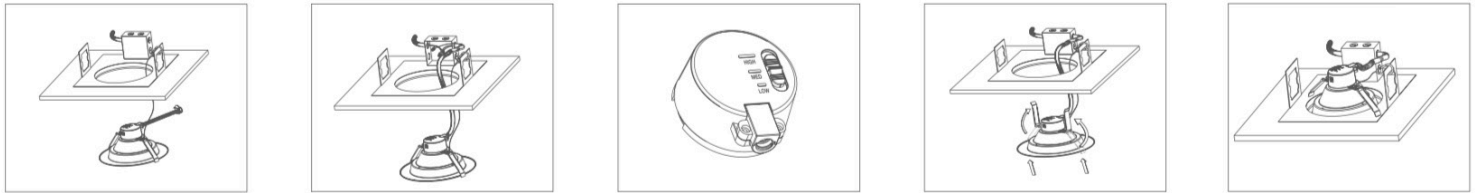

New Construction Installation



Model #	Size	Wattage	CCT	Nominal Lumen Output
USALED-DLM6	6 in	8.5W, 13.5W, 21W	3000K, 3500K, 4000K (adjustable)	700 lm, 1,000 lm, 1,500 lm
USALED-DLM8	8 in	12W, 19W, 26W	3000K, 3500K, 4000K (adjustable)	1,000 lm, 1,500 lm, 2,000 lm